

MURPHY AUDITORIUM-1ST FLOOR PLAN BANQUET LAYOUT #1

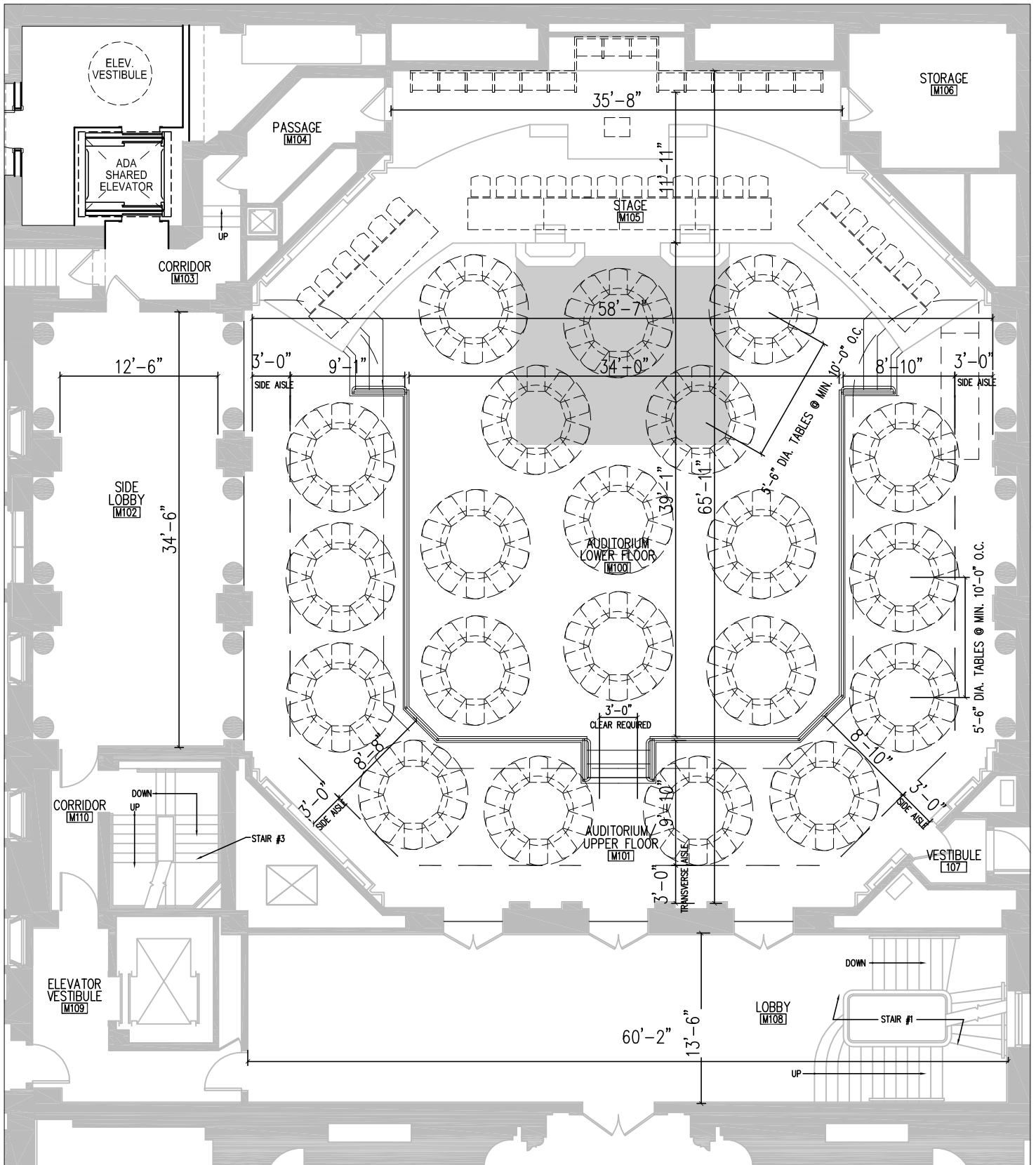

BANQUET LAYOUT #1

AUDITORIUM FLOOR

210 PEOPLE - (21) 66" DIA
TOTAL CAPACITY 210 PEOPLE

AUDITORIUM STAGE

18 PEOPLE - (6) 2'-6" X 6'-0" @ 3 EA
8 PEOPLE - (2) 2'-6" X 8'-0" @ 4 EA
2 PEOPLE - (2) TRIANGLES @ 1 EA
TOTAL 28 PEOPLE AT HEAD TABLE