

MURPHY AUDITORIUM-1ST FLOOR PLAN BANQUET LAYOUT #4

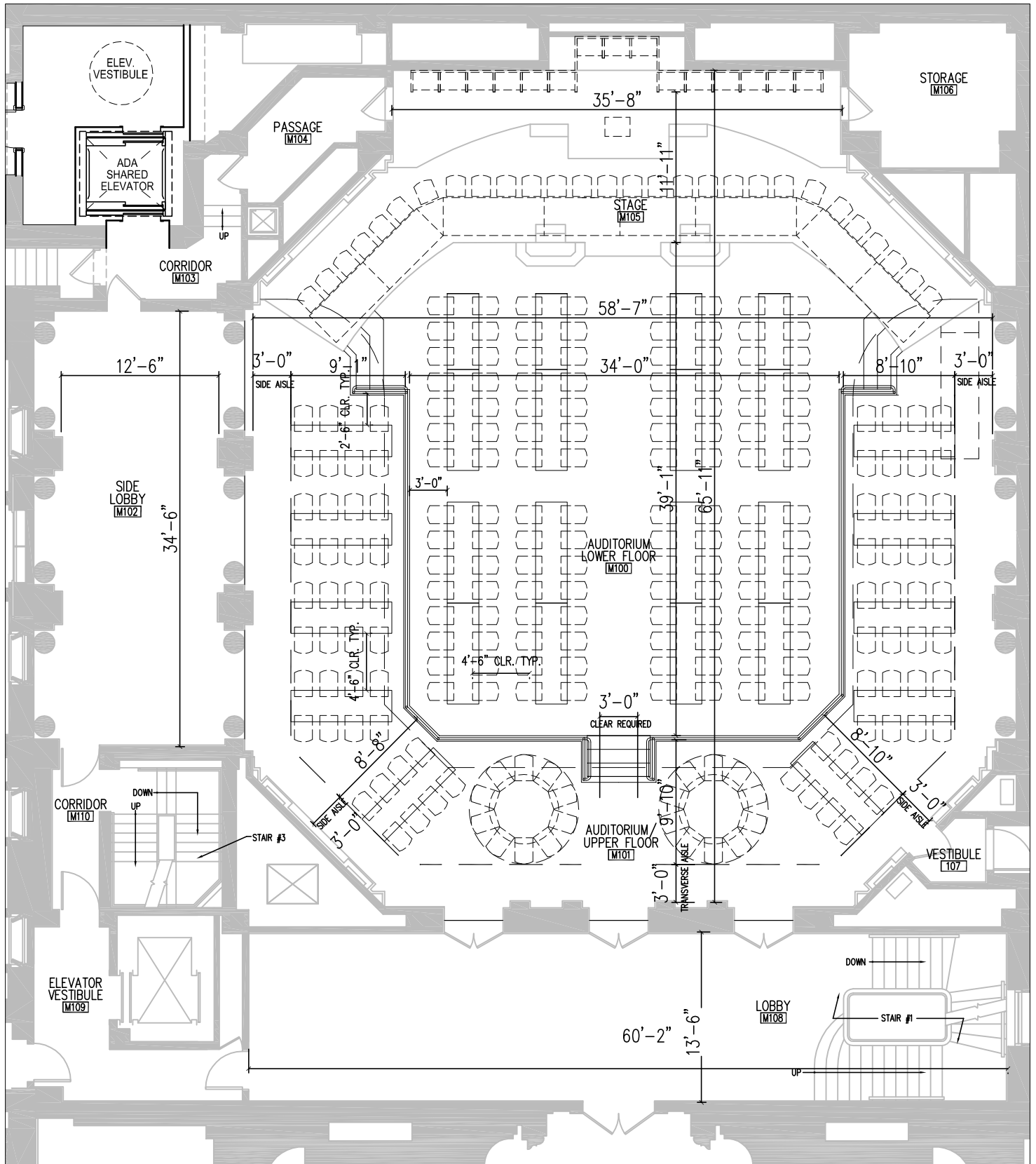

BANQUET LAYOUT #4

AUDITORIUM FLOOR

20 PEOPLE - (2) 5'-6" DIA @ 10 EA
 176 PEOPLE - (22) 2'-6" X 8'-0" @ 8 EA
 24 PEOPLE - (4) 2'-6" X 6'-0" @ 6 EA
 TOTAL CAPACITY 210 PEOPLE

AUDITORIUM STAGE

18 PEOPLE - (6) 2'-6" X 6'-0" @ 3 EA
 8 PEOPLE - (2) 2'-6" X 8'-0" @ 4 EA
 2 PEOPLE - (2) TRIANGLES @ 1 EA
 TOTAL 28 PEOPLE AT HEAD TABLE